

# Draw Works

P.O. Box 3294 St. George, Utah 84771 (435)634-1450

WWW.TheBestHomePlans.com

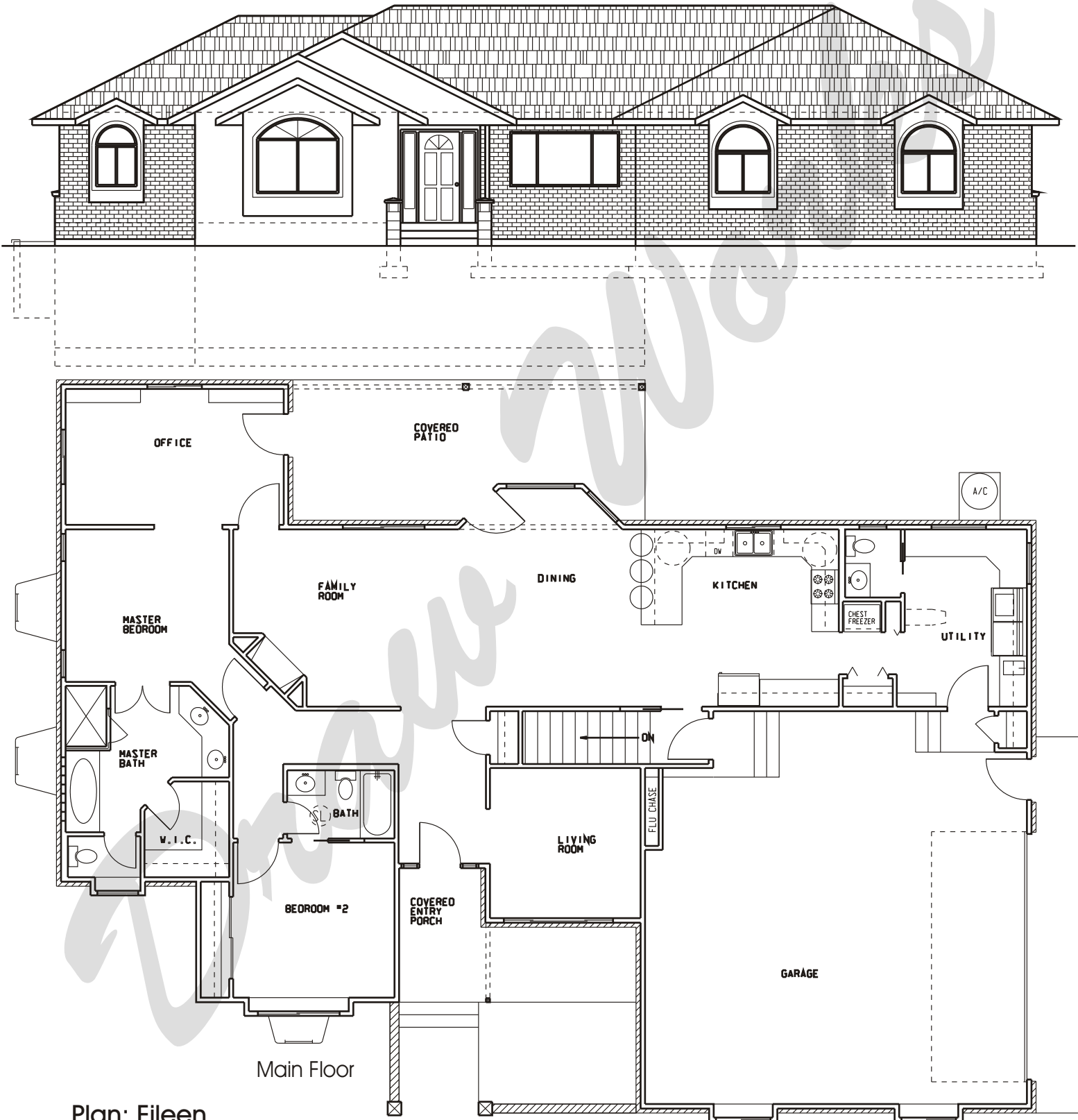

## Plan: Eileen

Square Feet: 1,946 Main 1,532 Unfinished Basement

Overall Dimensions: 71'-10" X 53'-9"

This plan is copyrighted by Draw Works and is protected under the copyright laws of the United States and may not be copied in any form. Draw Works will pursue prosecution of any violations.

